

**PRODUCT  
CATALOG**

**TMXFLOW**

**SB300  
TABLE BLENDER**

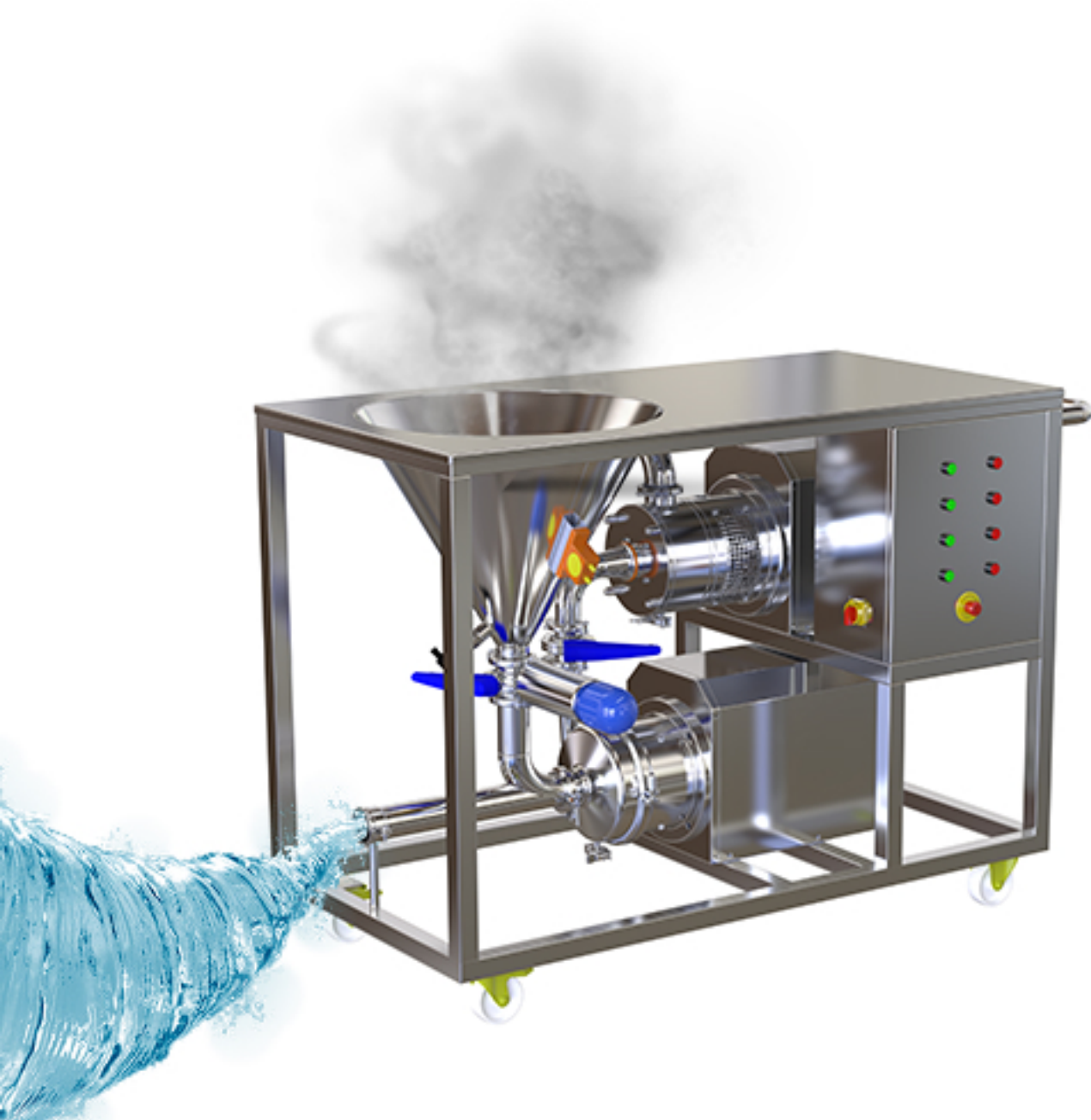



## Application

The Table blender can be used in order to dissolve powder into solid. It has a wide variety of application areas such as preparation of pharmaceutical syrups and pectin in glucose for marmelade production. In-line mixer can be included in system to handle with difficult mixing. The typical applications are reconstitution or stabilization of milk in the production of dairy products, and dissolution of sugar for the production of syrup in the beverage industries.

## Operation

Table blender consist of a centrifugal pump with a ventury system at the suction side and hopper with a butterfly valve. The suction system and ventury system are set horizontally. For difficult mixing, an inline mixer can be included after the centrifugal pump to reduce the size of possible lumps.

When the valve of the hopper opens. The solids are drawn from the hopper and are totally dissolved when they pass throught the casing of the pump.

## User Benefits

- Hygenic Design
- Cleaning and disinfection without disassembling the unit
- Very simple and effective equipment for homogeneous mixing.
- Fast powder dissolving
- High dynamic shear.

## Materials

Parts in contact with the product .....	AISI 316L
Other steel parts .....	AISI 304
Gaskets in contact with the product .....	EPDM
Internal and hopper .....	Bright polish Ra ≤ 0.8 μm

## Mechanical Seal

Rotary part .....	Silicon carbide (SiC)
Stationary part .....	Silicon carbide (SiC)
Gaskets .....	EPDM

## Options

- Double mechanical seal.
- Solenoid valve for the seal cooling system.
- Gaskets: FPM or PTFE.
- Connnections: DIN, SMS, CLAMP
- Vibrator for hopper.
- Frequency converter for the centrifugal pump.
- Pneumatically actuated valve + lower level sensor for solids.
- Hygienic upper level sensor for solids.
- Control panel for the vibrator, level sensors, frequency converter and automated valve.

- Hyginic design.
- ISO 2852 Clamp connections for easy assembly/disassembly
- Cleaning and disinfection without disassembling the unit.
- Complete mixing with recirculation.
- Manually actuated butterfly valve for hopper.
- Hopper welded to the table with a totally smooth easy-to-clean surface.
- SS control panel with start/stop button and motor protection.
- Skid with wheels: 2 rotating + 2 fixed with B5 flange and B3 legs, in compliance with the IEC standarts,
- 2 poles = 3000/3600 rpm, efficiency class according to EC regulation,
- IP 55 protection and F-Class insulation.

## Operating Data

TYPE	Centrifugal Pumps	In-line mixer	Flow (m <sup>3</sup> /h)	Solid Capacity* (kg/h)				Hopper (L)
	Power (Kw)	Power (Kw)		Sugar up to 25° brix	Sugar up to 50° brix	Milk powder 20%	Thickener up to 400 cP	
SB-300-1	3	-	25	1650	1350	950	300	45
SBM-300-1		4						
SB-300-2	7,5	-	40	3700	2400	3300	650	45
SBM-300-2		7,5						
SB-300-3	18,5	-	95	12800	8900	9200	600	75
SBM-300-3		18,5						

## Dimension SB-300

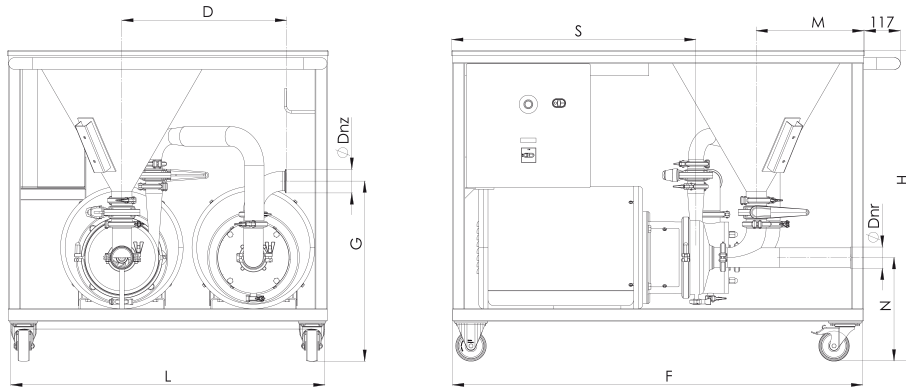

### DIMENSIONS

TYPE	Ø DNr	Ø DNa	D	G	S	N	L	F	H	M
SBM-300-026	2 1/2"	2"	161	603	649	320	710	1190	1000	353
SBM-300-035	2 1/2"	2"	194	660	797	337	740	1340	1014	353
SBM-300-038	4"	2"	240	849	1056	470	850	1770	1268	448
SBM-300-026M	2 1/2"	2"	134	564	702	320	970	1190	1000	353
SBM-300-035-M	2 1/2"	2"	136	588	844	337	1040	1340	1014	353
SBM-300-038-M	4"	3"	181	773	1090	470	1280	1770	1268	448

### CAPACITY

Liquid (m <sup>3</sup> /h)	Powder (kg/h)	Power (kw)	Speed (rpm)	Weight (kg)
25	950	4	3000	220
40	3300	7,5	3000	305
95	9200	18,5	3000	650
25	950	4	3000	130
40	3300	7,5	3000	185
95	9200	18,5	3000	355

## Dimension SBM-300

