

**PRODUCT
CATALOG**

TMXFLOW

***SDB TANK
BOTTOM MIXER***





Application

Tank bottom mixer series of the high shear bottom of the tank mixers present a highly hygienic solution for the processes of dispersion, emulsifying, homogenisation and disintegration of solids in the food-processes-ing, cosmetics, pharmaceutical and fine chemistry industries.

These mixers can be used either in open or closed tanks at atmospheric pressure or under pressure/vacuum.

The bottom of the tank mixers are designed for the applications of the highly viscous media and intended for work with anchor type agitators.

Operation

High-speed rotation of the rotor blades pulls liquid and solid materials down to the center of the working head, providing a powerful suction.

The high speed and adjusted tolerances between the rotor and the stator result in high suction potential, the product is suctioned and driven to the centre of the head.

The product is suctioned from the upper part of the head and the rotor thrusts it radially.

Passing through the opening of the stator the product is mechanically sheared, the particles are sheared by the rotor at 20 m/s.

Finally this flow is hydraulically sheared leaving the stator through the slots at a high speed.

User Benefits

Fast, effective liquid mixing performance in tanks

Efficient gas and powder dispersion

Can be used as tank cleaning machine

Handles multiple applications

Unmatched, cost-effective mixing performance

Simplified, hygienic design, modest investment.

Options

Flushed mechanical seal.

Pressurised mechanical seal by means of a lip seal or double mechanical seal.

Disintegrating head. Fine screen head.

Bare shaft construction for big size models, transmission by pulleys and belts.

Assembly of cutters and propeller on the upper part of the rotor.

Surface finish: $Ra \leq 0,5 \mu m$ for the pharmaceutical applications.

Other motor protections.



Application

Tank bottom mixer series of the high shear bottom of the tank mixers present a highly hygienic solution for the processes of dispersion, emulsifying, homogenisation and disintegration of solids in the food-processes-ing, cosmetics, pharmaceutical and fine chemistry industries.

These mixers can be used either in open or closed tanks at atmospheric pressure or under pressure/vacuum.

The bottom of the tank mixers are designed for the applications of the highly viscous media and intended for work with anchor type agitators.

Operation

High-speed rotation of the rotor blades pulls liquid and solid materials down to the center of the working head, providing a powerful suction.

The high speed and adjusted tolerances between the rotor and the stator result in high suction potential, the product is suctioned and driven to the centre of the head.

The product is suctioned from the upper part of the head and the rotor thrusts it radially.

Passing through the opening of the stator the product is mechanically sheared, the particles are sheared by the rotor at 20 m/s.

Finally this flow is hydraulically sheared leaving the stator through the slots at a high speed.

User Benefits

Fast, effective liquid mixing performance in tanks

Efficient gas and powder dispersion

Can be used as tank cleaning machine

Handles multiple applications

Unmatched, cost-effective mixing performance

Simplified, hygienic design, modest investment.

Options

Flushed mechanical seal.

Pressurised mechanical seal by means of a lip seal or double mechanical seal.

Disintegrating head. Fine screen head.

Bare shaft construction for big size models, transmission by pulleys and belts.

Assembly of cutters and propeller on the upper part of the rotor.

Surface finish: $Ra \leq 0,5 \mu m$ for the pharmaceutical applications.

Other motor protections.

Configuration

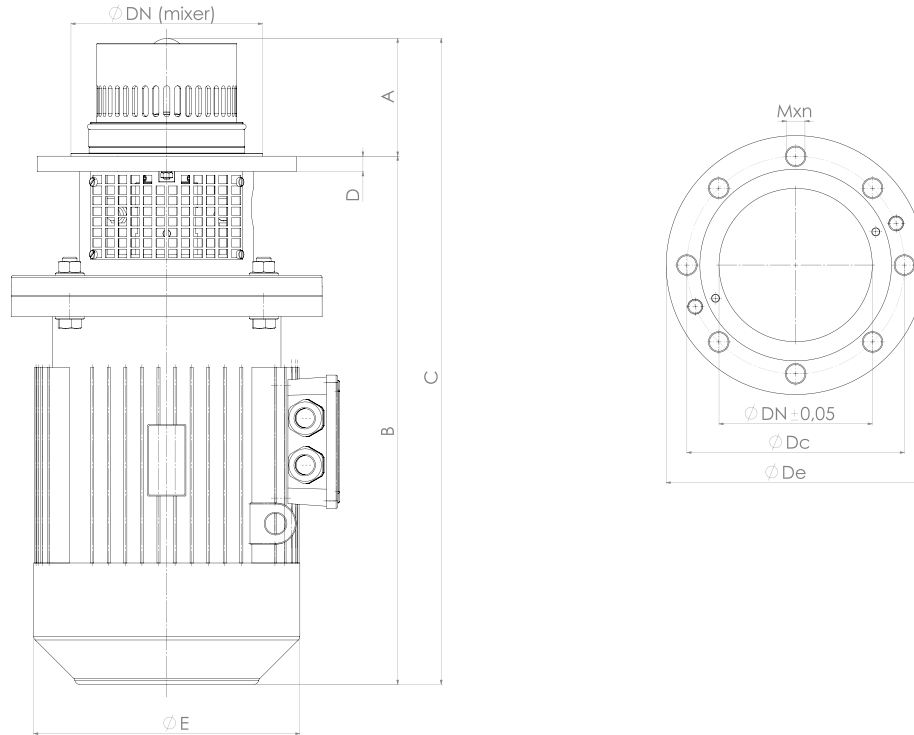

Dimensions

| TYPE | Ø Dn | Ø De | Ø Dc | m*n | A | B | C | D | Q | R |
|------------|------|------|-------|--------|-----|-----|-----|----|-----|-----|
| SDB-30-022 | 200 | 160 | 131,5 | M 16*4 | 82 | 355 | 437 | 18 | 180 | 122 |
| SDB-30-040 | 250 | 210 | 150 | M 16*8 | 87 | 436 | 523 | 15 | 236 | 148 |
| SDB-30-075 | 250 | 210 | 150 | M 16*8 | 87 | 492 | 579 | 15 | 261 | 163 |
| SDB-30-185 | 330 | 300 | 175 | M 16*8 | 108 | 656 | 764 | 26 | 310 | 208 |
| SDB-15-220 | 330 | 300 | 175 | M 16*8 | 144 | 730 | 838 | 26 | 349 | 223 |

Capacity

| TYPE | 3000 cpu | Additional agitation 3000 cpu | Power(kw) | Speed(rpm) |
|------------|----------|----------------------------------|-----------|------------|
| SDB-30-022 | 100 L | 300 L | 2,2 | 3000 |
| SDB-30-040 | 300 L | 750 L | 4 | 3000 |
| SDB-30-075 | 750 L | 1500 L | 7,5 | 3000 |
| SDB-30-185 | 1000 L | 2000 L | 18,5 | 3000 |
| SDB-15-220 | 1500 L | 2500 L | 22 | 1500 |